



Venue Accessibility Plan

Accessibility Information

Contact Information

Sub Club Melbourne

Official Address: Flinders Ct, Melbourne VIC 3000

Accessible Entrance: 35 Elizabeth Street, Melbourne VIC 3000

Email: info@subclubmelbourne.com

Phone: (03) 8614 5723

Trading Hours

Default operational hours

Fridays 2300 - 0600

Saturdays 2300 - 0600

Event running times subject to change, please check event pages on Facebook to confirm.



Getting to venue

If using public transport, the closest points to the venue are Flinders Street Station (Train) or Elizabeth Street / Flinders Street Railway stop (Tram) - Tram # 19, 57 and 59.

If you are driving, there is on street parking but is limited depending on how busy the city is. There are multiple night time parking buildings, closest being 300 Flinders Street.

Accessibility Entrance

Address: 35 Elizabeth Street, Melbourne VIC 3000

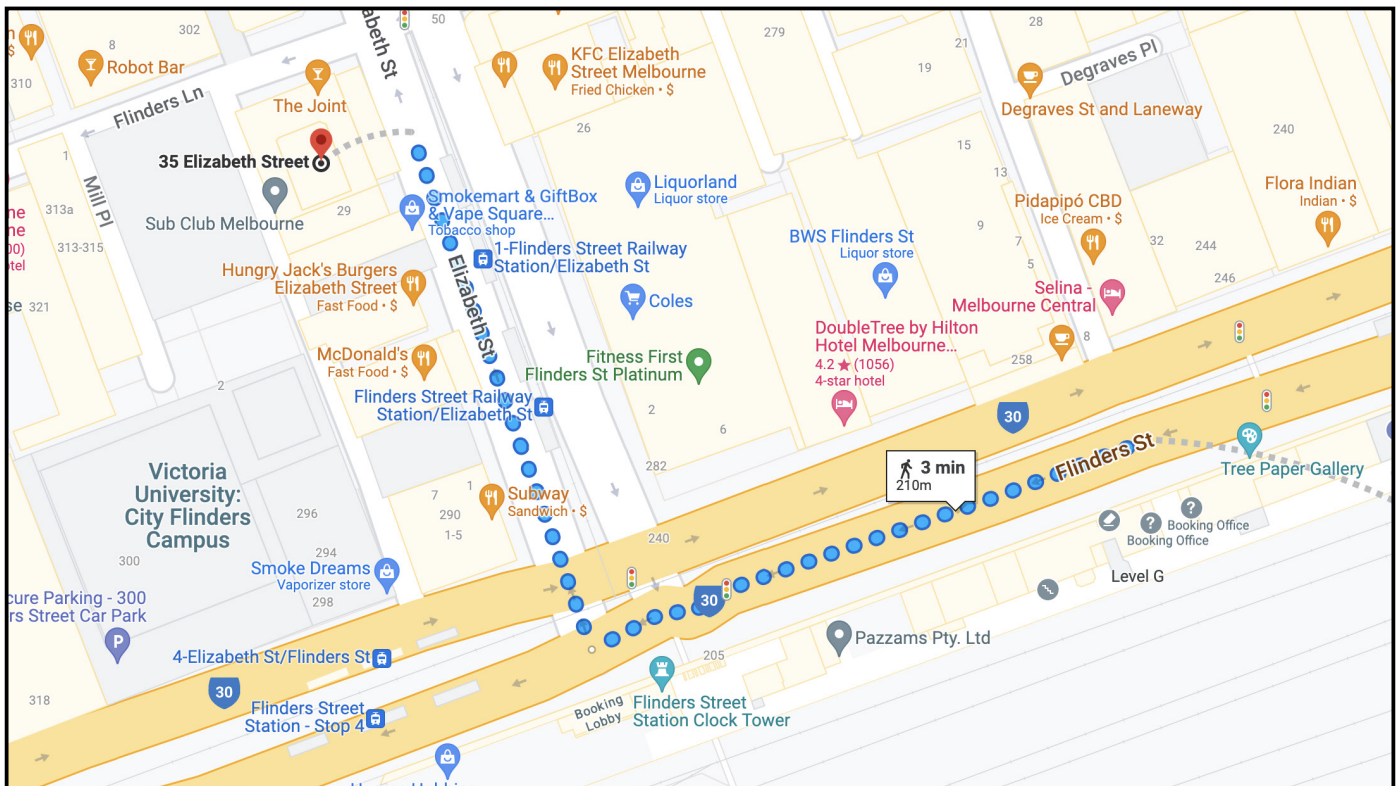

Access into venue

Our venue is located 2 levels under street level. The main entrance through the alley way has 2 flights of stairs until you reach the basement.

If you need wheelchair accesibility, we have an elevator that can reach the basement. Simply reach out to info@subclubmelbourne.com or simply ask one of our staff members or security guards that are stationed on the night to organise this for you.

Accessibility Entrance

Address: 35 Elizabeth Street, Melbourne VIC 3000



Building Entrance: View from Elizabeth St
Height: 26400mm
Width: 1290mm
Length: 5510mm



Building Entrance: View from entrance to Elizabeth St
Height: 26400mm
Width: 1290mm
Length: 5510mm

Access into venue

Once you go through the entrance ramp, and through the sliding door, you will be met with two accessible elevators.



Elevator door frame
Height: 2025mm
Width: 1065mm



Elevator inside
Height: 2130mm
Width: 1980mm
Depth: 1310mm

Toilet access

There is one accessible toilet available on the premises which is located on level 2. Please ask the assistance of one of our bar staff to give you access to the elevator to take you to this private toilet.

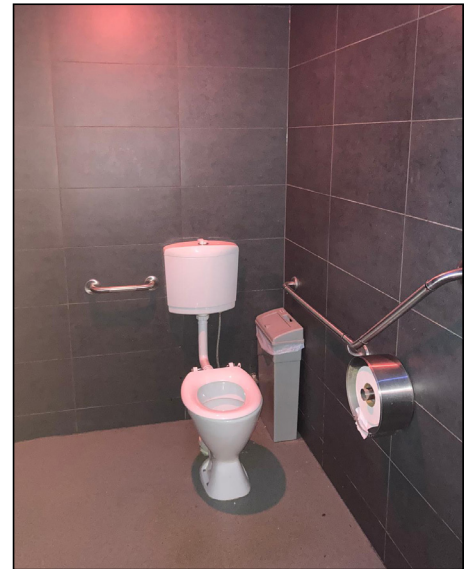
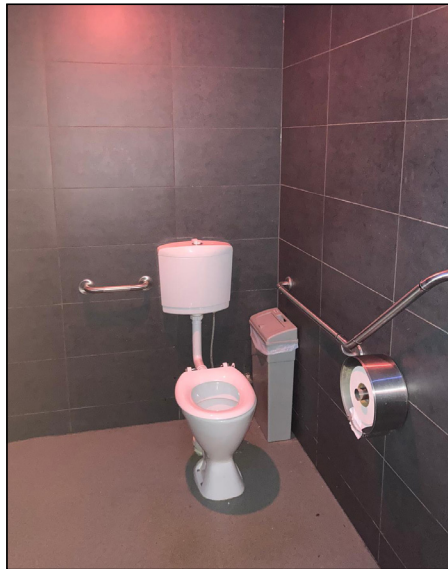

Door: 2040mm high x 920mm wide

Room

Height: 2040mm

Width: 1800mm

Depth: 2700mm

Sub Club basement floorplan

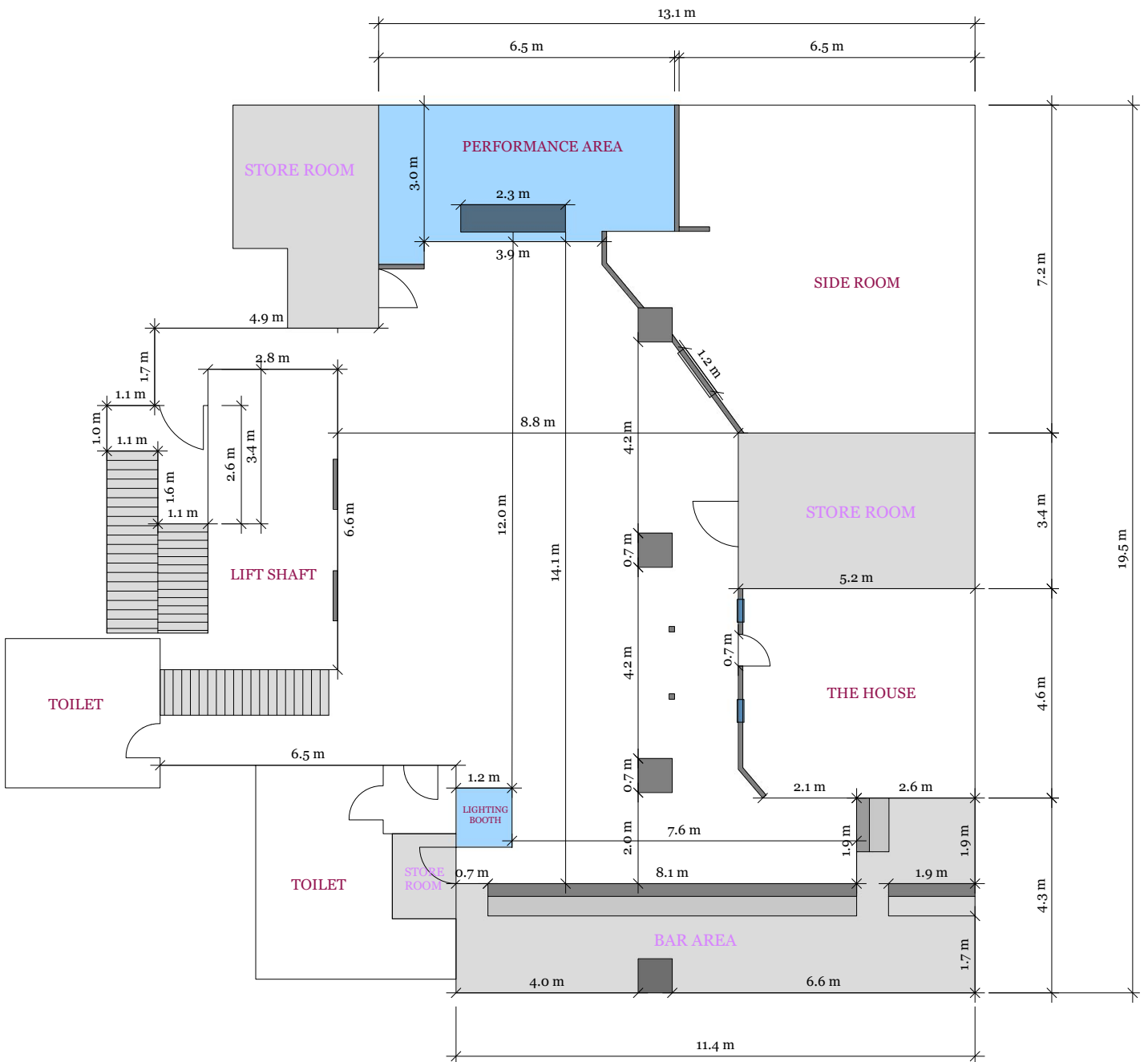

FAQ

Additional Notes:

Once in the venue, there are no additional steps, level access throughout.

Toilets:

All toilets at Sub Club are gender neutral with toilets downstairs being level access but do not have larger stalls with rails etc. The more comfortable option is on level 2, see Page 6 for more info.

Accessible Parking:

Please see [City Of Melbourne](#) website for more info.

Chill Out Area:

We have a large chill out area to the right of the DJ booth, though sound can still be heard from the main speakers.

Auslan Interpreters:

At this stage in time, Sub Club Melbourne does not have the infrastructure to provide Auslan Interpreters for our events.

Companion Tickets:

Sub Club Melbourne provides compensation for ticket prices for those who are acting as and hold Companion Cards.

Seating Arrangements:

Most events held Sub Club Melbourne are of standing / dancing nature in the main area, however there are many couches in the chill out area.

Free Entry for Aboriginal and Torres Strait Islander People:

We invite Aboriginal & Torres Strait Islander people in our community to any event, if they wish to come. There are an allocated amount of tickets for each event so please email bookings@subclubmelbourne for enquiries.

Lighting:

There is a warning that for all events that strobe lighting may be used. If you need further clarification regarding lighting for specific events please contact info@subclubmelbourne.com



